



Guides for a Smarter Home

ITC 499 Web Systems
Cole Buzzard and Brett Carusillo

9 December 2016



Project Summary and Overview

Intent: instruct first time users to successfully convert their home to a “smart home”.

We broke the web page down into 4 pages;

- Home

- Initial Insteon setup

- Amazon Echo integration

- Hardware required

Users can subscribe for future guides

- Information is stored in our database.

Project Scope

Create a webpage to show users how to easily turn their home into a “smart home”

Requirements

The webpage will include the use of the following programming language/tools; HTML (forms for user interactions), CSS, Client side script: JavaScript, Server-side script: PHP, MySQL database and data tables

Exclusions

Any type of external hardware

Out of pocket expenses

Milestones | Deliverables

Deliverable	Due by	Status
Basic website layout designed	11/14/2016	Complete
Creation of home page	11/21/2016	Complete
Creation of guide-page	11/21/2016	Complete
Creation of required hardware page	11/21/2016	Complete
CSS designed	11/21/2016	Complete
How-to guide example written	11/23/2016	Complete
Comments/Feedback section implemented	11/24/2016	Complete
SQL implemented	12/5/2016	Complete
Javascript implemented	12/5/2016	Complete
Webpage finalized	12/12/2016	Complete

Web System Design

System Requirements:

Minimum hardware requirements for XAMPP: + 64 MB RAM (RECOMMENDED) + 350 MB free fixed disk
+ Windows 2003, XP (RECOMMENDED), VISTA, Windows 7

Software Programming tools:

Notepad++

XAMPP

Visio

System Infrastructure Drawings:



Implementation and Testing

No severe issues were encountered

Minor issues with SQL implementation

Smooth process

Met all self-appointed deadlines

The Homepage

Home

Initial Insteon Smarthub Setup

Insteon Integration with Amazon Echo

Equipment Recommendations

Guides for a Smarter Home



Fri Dec 09 2016 11:51:32 GMT-0500 (Eastern Standard Time)

OK



About Us

This website features projects with simple step by step instructions to turn your home into a smarter home. Make your life simpler.

.....
Subscribe for updates to our guides!

Name:

Email:

Share:   

A closer look

The code for the alert:

```
<SCRIPT LANGUAGE = "Javascript">
var today= new Date()
</SCRIPT>
....
<BODY onload=alert(today)>
```

The code for subscribing:

```
<?php
function OpenCon(){
    $user = 'root';
    $pass = '1234';
    $db = 'dbsubscribe';
    $dbhost = '127.0.0.1';

    $dbcon = new mysqli($dbhost, $user, $pass, $db);

    return $dbcon;
}

function CloseCon($dbcon){
    $dbcon->close();
}
?>
```

```
<form method="post" action="index.html">
<input type="hidden" name="submitted" value="true" />
<fieldset>
    <legend>Subscribe To Us</legend>
    <label>First Name: <input type="text" name="firstname" /> </label>
    <label>Last Name: <input type="text" name="lastname" /> </label>
    <label>Email: <input type="text" name="email" /> </label>
</fieldset>
<br/>
<input type="submit" value="Subscribe to us!" />
</form>
```

```
1 <?php
2 include 'connect.php';
3
4 $dbcon = OpenCon();
5
6 echo "Connected Successfully";
7
8 CloseCon($dbcon);
9
10 ?>
```

```
<?php
if (isset($_POST['submitted'])) {
    include('connect.php');
    $firstname = $_POST['firstname'];
    $lastname = $_POST['lastname'];
    $email = $_POST['email'];
    $sqlinsert = "INSERT INTO users (firstname, lastname, email) VALUES ('$firstname', '$lastname', '$email')";
    if (!mysqli_query($dbcon, $sqlinsert)) {
        die('could not insert into database');
    }
    $recordadded = "record was added successfully";
}
?>
```

The CSS

Centered the page

Added a navigation pane

Added shadows and borders to pictures

Add a wallpaper

The PHP

Hit counter

Connection to database

Populate the database

Guide for Initial Setup

Home

Initial Insteon Smarthub Setup

Insteon Integration with Amazon Echo

Equipment Recommendations

Steps to install Insteon SmartHub and devices.

Download the software for PC here: <https://www.microsoft.com/en-us/store/p/insteon-for-hub/9wzdnrcdrh2v>

Download the software for Android here: <https://play.google.com/store/apps/details?id=com.insteon.insteon3&hl=en>

1. Plug in your plug-in devices to the desired outlets.
2. Plug in the smart hub to a power outlet.
3. Connect the hub to your wireless router or modem via the ethernet cable provided.
4. Log in with your insteon account or select New Account to create one.

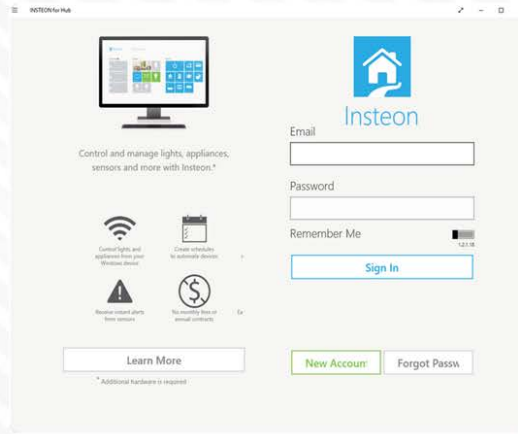

5. Upon logging in, Right click in the blank space and select Add device from the bottom bar that appears.



Integration with Amazon Echo

Home

Initial Insteon Smarthub Setup

Insteon Integration with Amazon Echo

Equipment Recommendations

Download the Android mobile app for Amazon Echo here: <https://play.google.com/store/apps/details?id=com.amazon.dee.app&hl=en>

1. Unbox and connect the Amazon Echo to a power source.
2. Once the mobile application is installed and opened on your mobile device the setup process will begin automatically.
3. To connect your Echo with your Insteon smart devices, navigate to the side bar in the application.

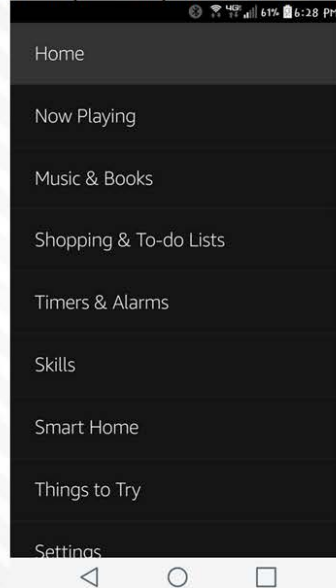

4. Select Smarthome.
5. Scroll down until you see the section titled "Your Smart Home Skills"



Recommended Hardware

Home

- Initial Insteon Smarthub Setup
- Insteon Integration with Amazon Echo
- Equipment Recommendations

Recommended Hardware

Insteon SmartHub - <http://www.insteon.com/insteon-hub>



Insteon Plug-In Devices - <http://www.insteon.com/plug-in-devices>

